

## XM-300 XPERIENCE CONTROLLER

### XM range

The nexmosphere modular range is the most versatile tool for providing unique shopper experience into your retail environment. Its scalable form factor, functionality and smart design make it an ideal controller to integrate in virtual any application. Connect any of the nexmosphere elements such as presence sensors, pick-up detectors, touch buttons or LED's to build your own unique shopper journey and optimize it based on the gathered detailed statistics insights the XM-range delivers day-to-day.

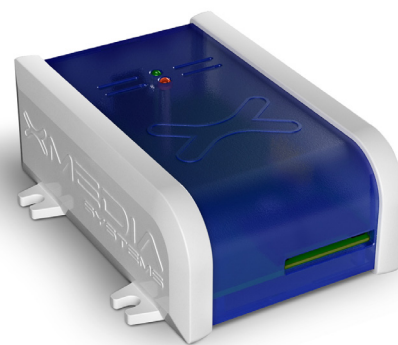

The controllers are the heart of the system. Expand them up to your specification with any of the EM expansion modules. Combine different functions like light, video & audio with X- scrips that can be easily configured and uploaded on the SD card. This SD card is also the storage center for all statistic data that will be gathered during operation to give you a full insight in how your application is being used and how it could be optimized.

### Features

- X-talk interface for easy sensor connection
- LocalBus & EM interface for system expansion

### X-script

X-script is the universal tool to combine all nexmosphere elements such as presence sensors, touch button's and LED's in to one big control matrix. It easily indicates the output effect a specific trigger will have and the Xperience controller will do such job. There is no need for programing skills, its easy excel style programing provides a unique flexibility to configure the system according to your creativity.

- Easy changeable script by the swap of an SD card
- Central control over all nexmosphere elements
- Excel style programming
- Create application specific shopper journey's

### EM expansion

Combine any of the EM modules to create an exact fit for your application. Whether it is the universal 8x X-talk interface, a 5 channel RGB led driver or one of the audio switching modules, all modules work seamlessly together without any need for configuration. See the EM product overview for all module details.

- Compatible with any of the EM- modules
- Connect up to 5 EM-modules to one XM-controller
- Pre assembled factory build for your application
- Auto system configuration
- All EM-modules can be centrally controlled by XM-controller

### Benefits

- Auto start-up and configuration for highly reliable standalone applications (24/7 operability)
- Automatic recovery to an attractive state after a period of inactivity
- Multiple data gathering functionalities offer unique insight into how your application is being used (DLX-200 X-talk data logger required)
- Easy changeable script enables a application or vending site specific shopper experience

# XM-300 XPERIENCE CONTROLLER

## Thermal specifications

Operating temperature: +10°C...+40°C/ +50°F ... +104°F  
Storage temperature: -20°C...+50°C/ -4°F ... +122°F  
Cooling: Passive cooling (no moving parts)

## Electrical specifications

Operating voltage: 5VDC  
Power consumption: 150mA  
Max. system current: 2A  
Overload protection: Yes  
Reverse polarity protection: ??????

## Standards and Certifications

Compliant with IEC 60950-1(ed.2);am1;am2  
CE certificate  
US/CAN certification in progress  
RoHS compliant

## Miscellaneous

- Robust housing with screw brackets for secure fixing
- Build-in magnets for easy mounting on metal surfaces
- Both horizontal & vertical mounting allowed
- Diagnostic LED indicating potential issues
- Status LED indicating power & input/output operations
- 1 year warranty (optional 3 year extended warranty available)

## Packaging

Netto Weight: 104g  
Items per carton 1 or 10 pcs

## Mechanical dimensions

LxWxH: 94 x 76 x 36 mm  
Screw fixation: 54 x 69,7 mm

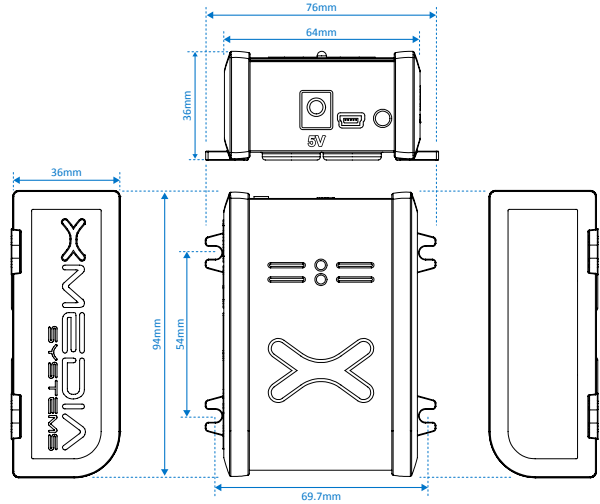

## Hardware interfaces

1. LocalBus 2.5mm Jack socket
2. X-talk+ interface
3. 5V Power input 2.5mm DC socket
4. SD card slot for X-script and Audio-files & statistics

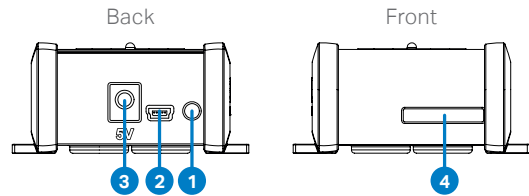

## Ordering information

Product ID	Description	Quantity
XM-300	Xperience controller, LocalBus, 1x X-talk	1 pc

## Nexmosphere

High Tech Campus 10 (Mμ building)  
5656 AE Eindhoven • The Netherlands

T +31 40 240 7070  
E sales@nexmosphere.com

© 2017 Nexmosphere. All rights reserved. v1.0 / 02-17  
All content contained herein is subject to change without prior notice.